

Engineering Detail

WSG High Performance Silica Gel Desiccant
 LT3 Molecular Sieve Desiccant

NovelAire Model No.	Flow Rate (scfm) 75/25	Flow Rate (scfm) 50/50	Wheel Diameter (mm)	Wheel Depth (mm)	Cassette Height/Width A (inches)	Cassette Depth B (inches)	Approx. Total Wt. (pounds)	Drive Motor (Hp)
250	200	150	250	200	21	11.5	90	1/80
370	500	350	370	200	24	12	110	1/80
440	700	500	440	200	26	12	120	1/80
550	1000	750	550	200	29	12	150	1/80
770	2000	1500	770	200	36	12	220	1/80
965	3500	2500	965	200	43	13	290	1/80
1070	4500	3000	1070	200	48	13	330	1/80
1220	6000	4000	1220	200	54	13	410	1/40
1525	8500	6000	1525	200	69	14	790	1/40
1730	11000	7500	1730	200	77	15.5	1020	1/6
1940	14000	10000	1940	200	85	15.5	1370	1/6
2190	18000	12500	2190	200	96	17	1730	1/6
2438	22500	16000	2438	200	106	17	2000	1/6
2743	28000	20000	2743	200	122	18.25	2740	1/6
3050	35000	25000	3050	200	134	18.25	3390	1/6

Note: NovelAire desiccant wheels are offered in a standard depth of 200 mm. Optional 50mm, 100mm, 150mm and 400mm depths are available in some sizes. Please consult the factory for depth options and dimensional tolerances.

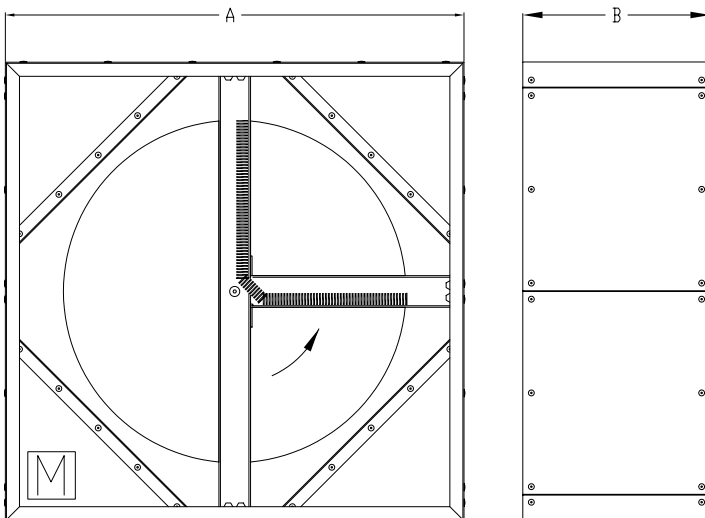

NOVELAIRE TECHNOLOGIES

HEAT & MASS TRANSFER PRODUCTS

10132 Mammoth Avenue
 Baton Rouge, LA 70814-4420
 Phone: (800) 762-1320 or
 (225) 924-0427
 Fax: (225) 930-0340
 Website: www.novelaire.com

The information contained in this brochure is believed to be accurate by NovelAire Technologies, but is not warranted.